

NOTES:

TITLE
HOT AIR STERLING ENGINE (HEISSLUFTMOTOR)
TO THE DESIGN OF FRANK ARBEITER

DRAWING CONTENTS

GENERAL ARRANGEMENT
VIEW AND BILL OF MATERIAL

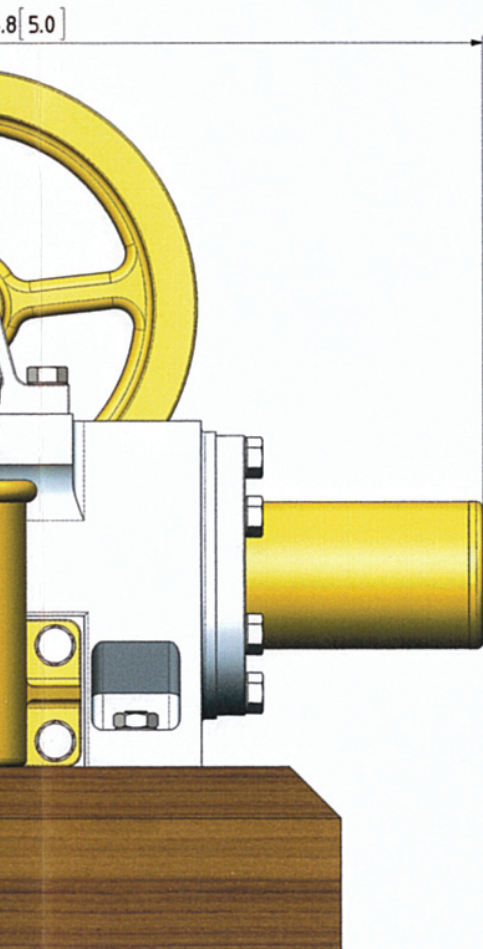
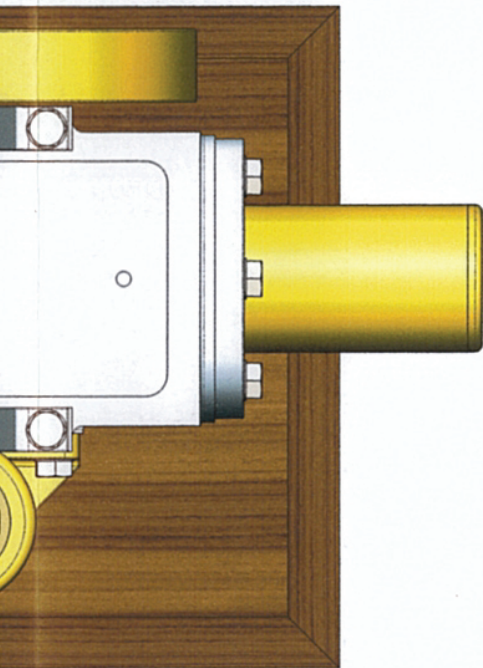

QTY.	PART NUMBER
1	FRANK-01-BASE CYLINDER BLOCK
1	FRANK-02-PIVOT LEVER BEARING BLOCK
2	FRANK-03-MAIN CRANKSHAFT BEARING BLOCK
1	FRANK-04-DISPLACER CYLINDER
1	FRANK-05-DISPLACER CYLINDER SEAL-1
1	FRANK-06-DISPLACER CYLINDER SEAL-2
2	FRANK-07-PIVOT LEVER BEARING BUSH
2	FRANK-08-MAIN CRANKSHAFT BEARING BUSH
1	FRANK-09-DISPLACER CYLINDER
1	FRANK-10-DISPLACER CYLINDER LID
1	FRANK-11-POWER CYLINDER
1	FRANK-12-DISPLACER CYLINDER END
2	FRANK-13-DISPLACER CYLINDER END BUSH
1	FRANK-14-BASE CYLINDER BLOCK PLUG
1	FRANK-15-BASE CYLINDER BLOCK TOP LID
1	FRANK-16-FLYWHEEL
1	FRANK-17-FLYWHEEL KEY
1	FRANK-18-MAIN CRANKSHAFT
1	FRANK-19-CRANK KEY
1	FRANK-20-POWER PISTON CRANK
1	FRANK-21-POWER PISTON CON ROD PART-1
2	FRANK-22-POWER PISTON CON ROD PART-2
1	FRANK-23-POWER PISTON CON ROD BEARING BUSH-1
1	FRANK-24-POWER PISTON CON ROD BEARING BUSH-2
1	FRANK-25-POWER PISTON
1	FRANK-26-POWER PISTON CON ROD CONNECTOR
1	FRANK-27-PISTON PIN
1	FRANK-28-DISPLACER PISTON CON ROD PART-1
1	FRANK-29-DISPLACER PISTON CON ROD BEARING BUSH-1
1	FRANK-30-DISPLACER PISTON CON ROD BEARING BUSH-2
1	FRANK-31-DISPLACER LEVER
1	FRANK-32-DISPLACER ROD CONNECTOR
2	FRANK-33-DISPLACER LEVER PULL ROD
1	FRANK-34-DISPLACER ROD
1	FRANK-35-DISPLACER PISTON
1	FRANK-36-DISPLACER PISTON LID-1
1	FRANK-37-DISPLACER PISTON LID-2
1	FRANK-38-WOODEN BASE
1	FRANK-39-PIVOT PIN
1	FRANK-40-POWER PISTON CON ROD SMALL END PIN
2	FRANK-41-DISPLACER LEVER BOTTOM END PIN
1	FRANK-42-POWER PISTON CRANK PIN
2	FRANK-43-LOCKING PIN
5	FRANK-M2-NUT
1	FRANK-M2x4 GRUB SCREW
2	FRANK-M2x8 HEX BOLT
26	FRANK-M3 WASHER
4	FRANK-M3-NUT
1	FRANK-M3x7
21	FRANK-M3x12
3	FRANK-M3x21.5

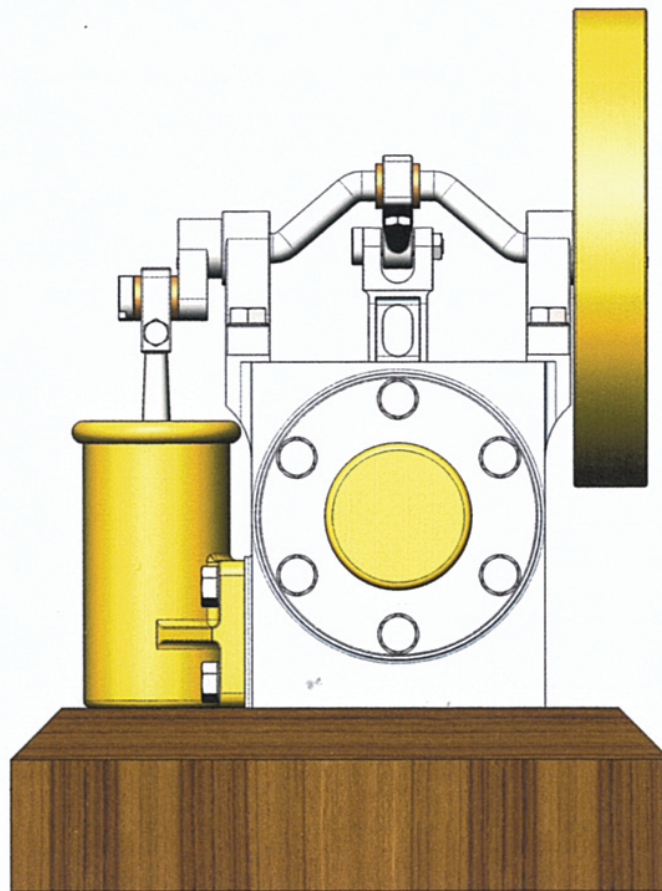

ENT, ISOMETRIC
ATERIALS

PROJECT No 05A-08-00

JDW DRAUGHTING SERVICES

J.A.M. DE WAAL, 12 BRIGHTWELL STREET PAKAPURA 2110,
NEW ZEALAND. PHONE: 0064 09 2988815. MOB: 0211791000
E-MAIL: dewaal@xtra.co.nz.

PROJECTION

DATE

JULY-2014

SHEET:01 OF 03

JDWDS

MODEL SCALE: 1:1

DWG SCALE: 1:1 @A3 OR AS SHOWN

Copyright © J.A.M. DE WAAL PAKAPURA NZ

A3 No:05A-08-00-SHT01

FOR PERSONAL USE ONLY NOT FOR COMMERCIAL PURPOSES

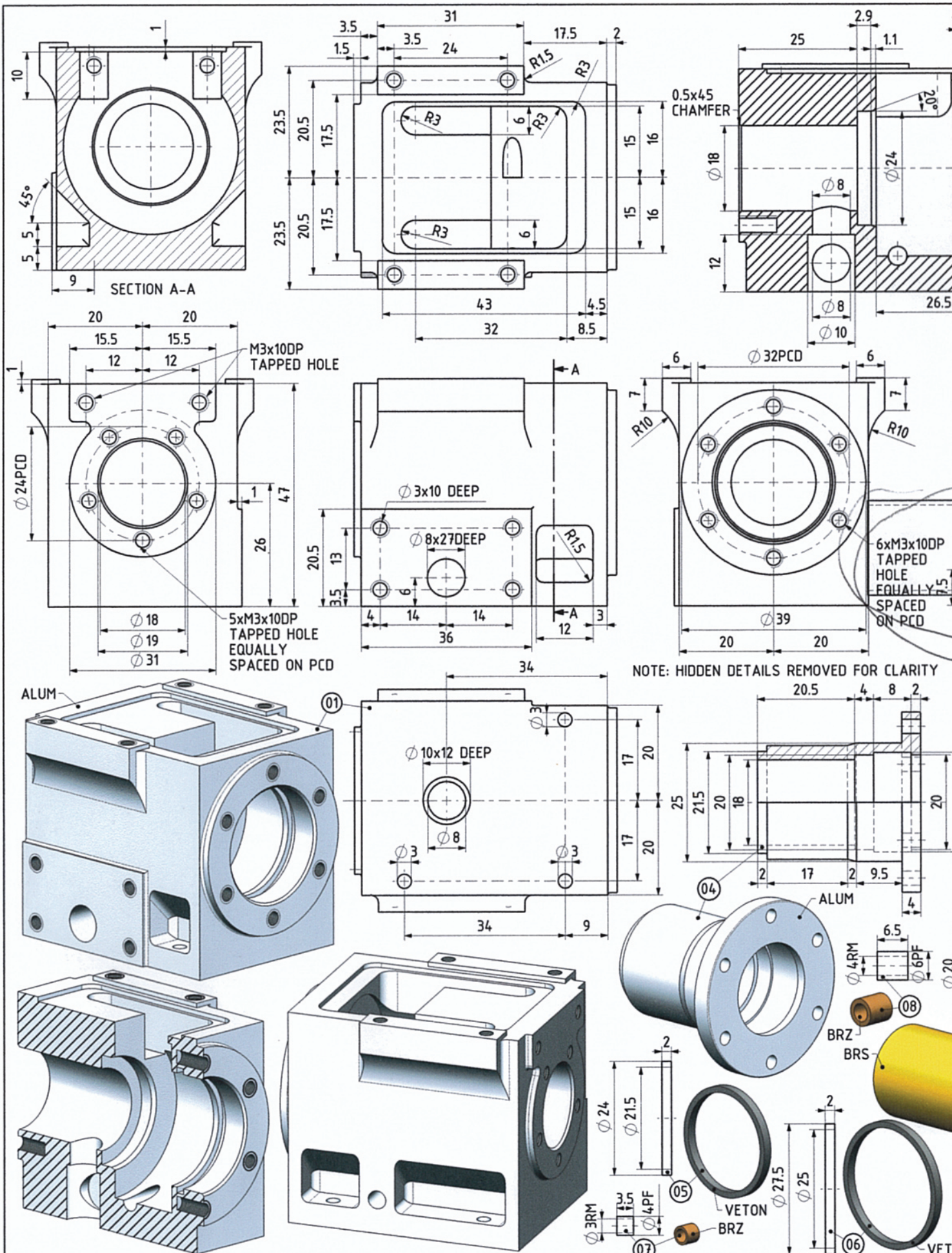

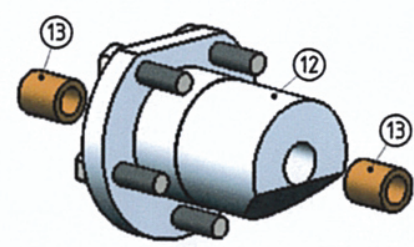
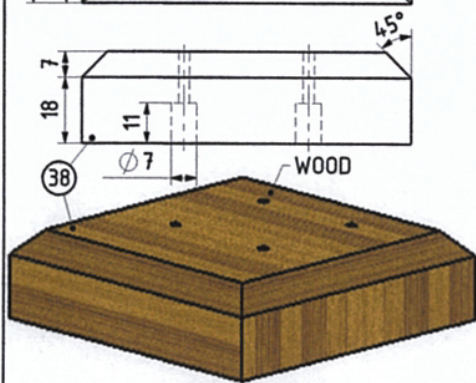
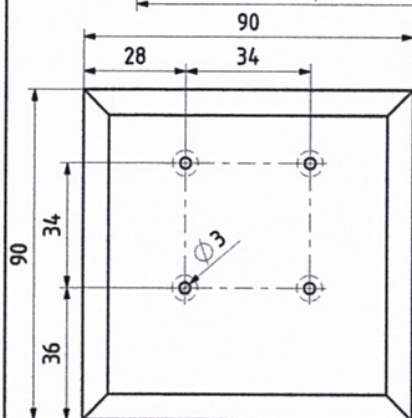
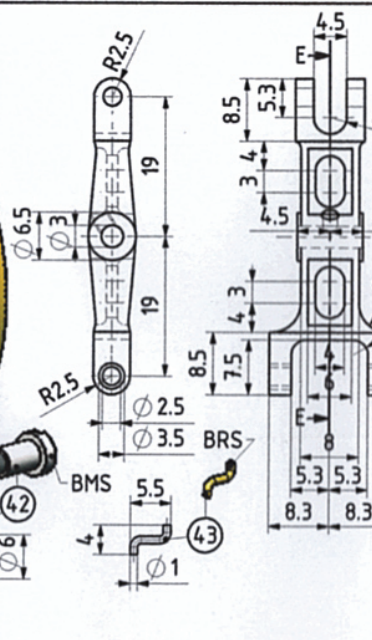
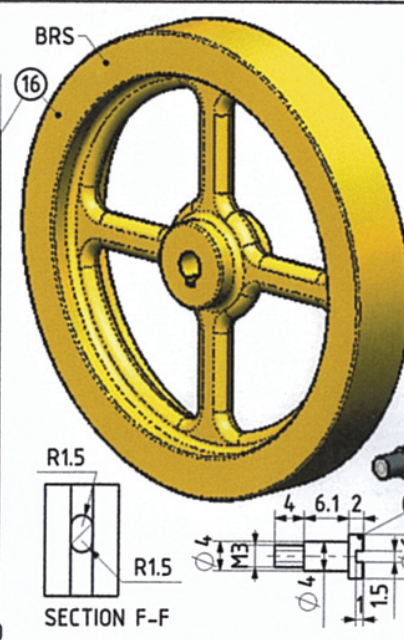
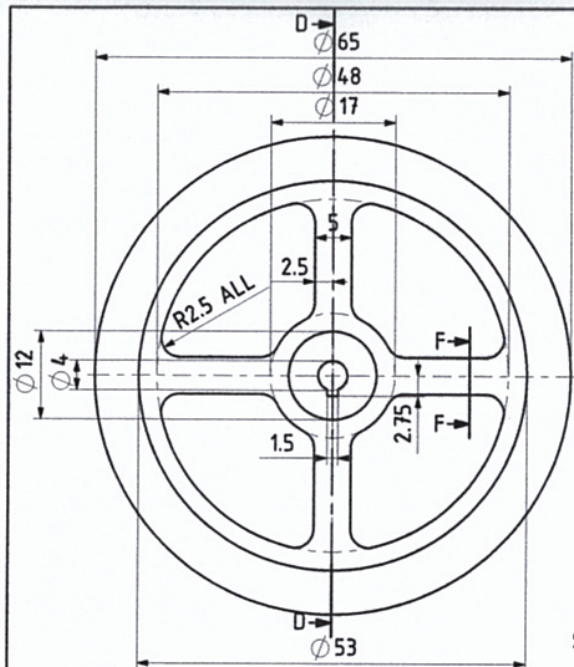

SA-104



SA-101

SA-102

SA-103

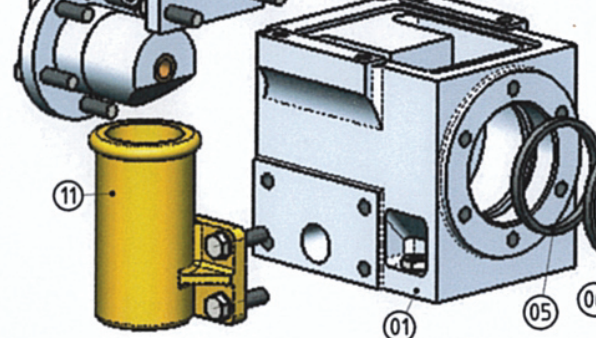

SA-105

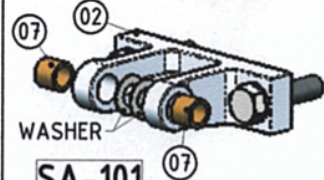

SA-101

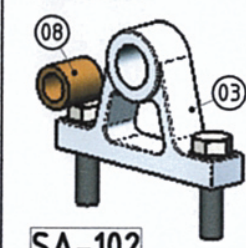

SA-102

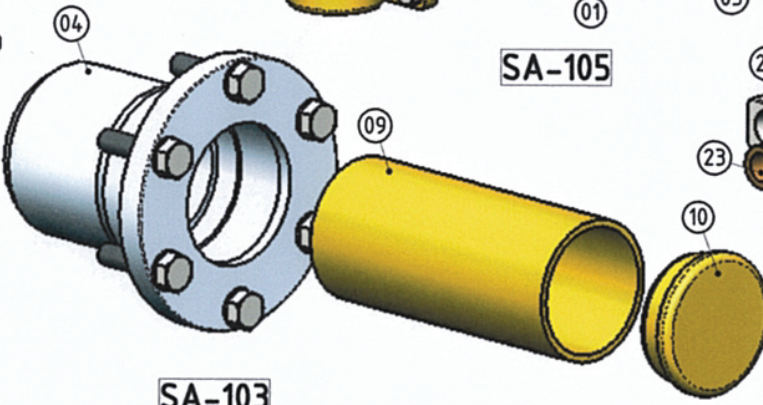

SA-103

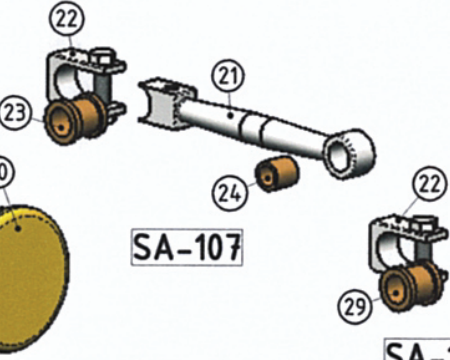

SA-107



SA-109

NOTES:

TITLE
HOT AIR STERLING ENGINE (HEISSLUFTMOTOR)
TO THE DESIGN OF FRANK ARBEITER

DRAWING CONTENTS
PARTS AND ASSEMBLY

